

### SPECIAL FEATURES

- CASE & MEASURING SYSTEM IN SS
- DRY OR LIQUID FILLED
- ACCURACY UP TO 1.0% F. S.
- STANDARD FOLLOWED IN GENERAL EN 837 - 3

### APPLICATIONS

CHEMICALS / REFINERY / NUCLEAR / AEROSPACE / FERTILIZER  
/ PETROCHEMICALS / PHARMACEUTICAL / POWER / CEMENT /  
SUGAR / FOOD & BEVERAGES / PULP / PAPER & ALLIED PROCESS  
INDUSTRIES.

### SPECIFICATIONS

#### STANDARD VERSION : 150 mm

<b>Accuracy</b>	: $\pm 1.6\%$ of F. S. for ranges up to 1 bar
	: $\pm 1.0\%$ of F. S. for ranges 1 bar to 16 bar
<b>Ambient temperature</b>	: - 25°C to + 65°C
<b>Process temperature</b>	: Max 100°C
<b>Static pressure</b>	: 6 kg/cm <sup>2</sup> up to ranges 0.4 bar
	: 25 kg/cm <sup>2</sup> for ranges 1 bar to 2.5 bar
	: 40 kg/cm <sup>2</sup> for ranges 4 bar to 16 bar
<b>Case &amp; Bezel</b>	: AISI 304 SS (Bayonet Type)
<b>Bellow</b>	: AISI 316L SS
<b>Process Connection</b>	: 1/2" NPT(M) x 2 Nos.
<b>Movement</b>	: AISI 304 SS

<b>Protection</b>	: IP 65
<b>Dial</b>	: Aluminum, black graduation on white background
<b>Pointer</b>	: Aluminum, black coloured, Micrometer Zero Adjustable
<b>Window</b>	: Shatterproof / Safety Glass
<b>Gasket &amp; Filling Plug</b>	: Neoprene
<b>Blow Off Disc</b>	: Neoprene
<b>Scale Amplitude</b>	: 80° to 270° - Non linear (Depends on Range)

#### GLYCERINE FILLED VERSION (OPTION PY)\*

<b>Accuracy</b>	: $\pm 1.0\%$ of F. S.
<b>Ambient Temperature</b>	: Maximum 65°C
<b>Process Temperature</b>	: Maximum 65°C
<b>Window</b>	: Plexi Glass
<b>Dampening Liquids</b>	: Glycerin 99.7%
<b>Other Features</b>	: Refer Specification of Standard Version

\*Suitable for ranges 1 bar to 16 bar

#### Temperature effect:

The variation of indication caused by effects of temperature is to be calculated by below formula;  
which is to be added in the specified accuracy while measurement :-  
Formula :  $\pm 0.08 \times (t_2 - t_1) \% \text{ of F. S.}$   
where  $t_1$  = reference temperature (+20°C) and  $t_2$  = ambient temperature in °C.



#### DIMENSIONS - STANDARD VERSION

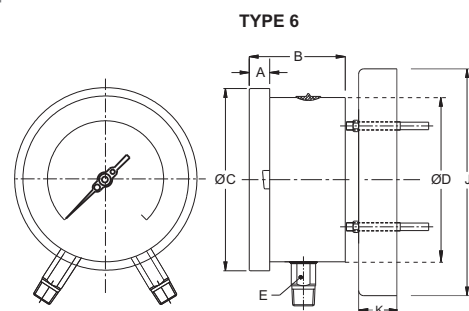
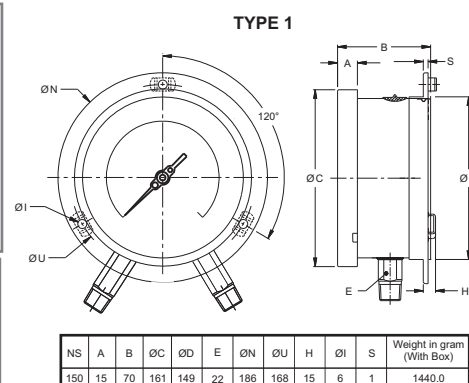

**Notes :**

- Drawings are not to scale.
- All Dimensions are in mm.
- NS = Nominal Size

## RANGE TABLE

**Note :** Waaree offers National / International Scales like kPa, MPa, bar, psi, kg/cm<sup>2</sup>, mbar, mWC, inWC & Dual Scale like kPa with psi, kPa with bar, bar with psi or Equivalent scales as per the requirement can be provided on request. Scales for floor are also available.

Following are the example tables for kg/cm<sup>2</sup> & mmWC

## PRESSURE RANGE (Single Scale)

Low Pressure mmWC	High Pressure			
	kg/cm <sup>2</sup>	kg/cm <sup>2</sup>	kg/cm <sup>2</sup>	kg/cm <sup>2</sup>
0/4000	0/1	0/2	0/4	0/10
0/6000	0/1.6	0/2.5	0/6	0/16

Note : Other Scale are available on customer request.

## ACCESSORIES

### MANIFOLDS

(Refer Individual Datasheet for complete specifications)

## HOW TO ORDER

[It is recommended to use manifolds along with Differential Pressure Gauges for better performance and safety.]

### BASIC MODEL

<b>CODE</b>	H	<b>BQ</b>
<b>NOMINAL SIZE</b>	150 mm	<b>X</b>
<b>TYPE OF MOUNTING</b>		
1 WALL / SURFACE / PROJECTION MOUNTING WITH BOTTOM ENTRY		<b>X</b>
6 2" PIPE / YOKE MOUNTING WITH BOTTOM ENTRY (Mounting bracket will be provided of steel epoxy painted.)		
<b>PROCESS CONNECTION</b>		
4NM 1/2" NPT (M) x 2 Nos.(Standard)		<b>XXX</b>
<b>Note : Connections like Metric/ PT/ PF/ Flaired/ UNF/ G/ R etc can be provided on request. Consult factory for price &amp; delivery.</b>		
<b>BELLOW</b>		
GU AISI 316L SS (Standard)		<b>XX</b>
<b>RANGE</b>		
REFER RANGE TABLE		<b>0 / 2 kg/cm<sup>2</sup></b>
<b>OPTIONS</b>		
PS AISI 316 SS CASE & BEZEL	TF CONFORMITY AS PER NACE MR 0175	<b>XX</b>
PY DAMPENING LIQUID GLYCERINES	PU CALIBRATION CERTIFICATE TRACEABLE TO NATIONAL/INTERNATIONAL STANDARDS	
QA DAMPENING LIQUID SILICON OIL**S	PW FIVE POINT CALIBRATION CERTIFICATE	
RH CUSTOM DESIGNED DIAL	GH MATERIAL TEST CERTIFICATES#	
SW DIAL TAG MARKING	JU 2" PIPE/YOKE MOUNTING BRACKET & 'U' CLAMP (AISI 304 SS)	
SX SS TAG PLATE	FN 2" PIPE/YOKE MOUNTING BRACKET & 'U' CLAMP (AISI 316 SS)	
SJ MAXIMUM READING POINTER WITH PLEX GLASS (FOR DRY VERSION)*	RZ TOUGHENED GLASS	

\* For ranges 2.5 kg/cm<sup>2</sup> and above.

\*\* Gasket & Plug of NBR. Refer Price List for Viton.

♣ Suitable for ranges 1 bar to 16 bar

# MATERIAL TEST CERTIFICATES WILL BE PROVIDED FOR WETTED PARTS ONLY WITH CHEMICAL COMPOSITION TESTING. FOR OTHERS, PLEASE CONSULT FACTORY.

**Note :** For selection of Diaphragm Seals, refer individual data sheets.

(THE CAPILLARY LENGTH SHALL BE MAXIMUM UP TO 3 METERS & RANGE SHALL BE ABOVE 1 kg/cm<sup>2</sup>.)

**Ordering Example: BQ - X - X - XXX - XX - 0/2 kg/cm<sup>2</sup> - XX**

FOR OTHER OPTIONAL ITEMS, PLEASE CONTACT FACTORY FOR DELIVERY AND MINIMUM QUANTITY OF ORDER.

**Note :** Specifications and dimensions given in this product catalogue represents the state of engineering at the time of printing.

Modifications may take place and materials specified may be replaced by others without prior notice.